



X105 Product Show



双通道



单通道

Functions & Features

- 1、 Reasonable and reliable design, low noise, smooth operation and long service life;
- 2、 Using brushless motor, cooperating with our professional machine core, the function is more powerful.
- 3、 LED indicator, valid card showing green, illegal card showing red;
- 4、 Card can be set "with memory" or "without memory";
- 5、 With automatic reset function, i.e. after having access to the gate, the gate automatically restores to the locked state if not pass within the time set;
- 6、 Compatible with IC, ID card, scanning and face recognition;
- 7、 With unified and standard external electrical interface to facilitate system integration;
- 8、 Extensible to realize access control, attendance, fees and other functions;
- 9、 Can be used outdoors completely, one machine can be used as a lane.

Parame-

Material	1.2/1.0mm SUS304
Size	1200*280*980mm
Sensor pairs	NA
Pass rate	35p/m
Pass width	550mm
Input voltage	100V~240V
Motor type	NA
Environment	-20~+70°C
Power supply	24V 50W
Net weight	45kg

Product

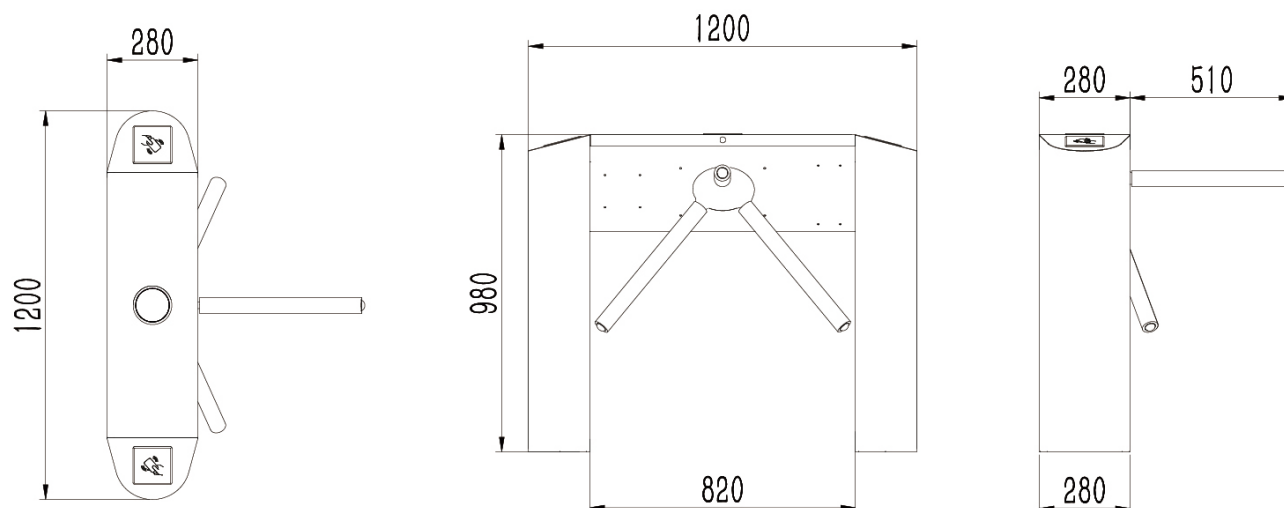

Case share

